

# *De Mayo RoTractor® Assembly Instructions for positioners with pulleys*

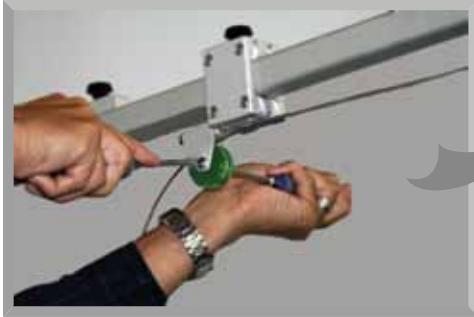

1.) Remove the screw from the 2nd pulley from the end.

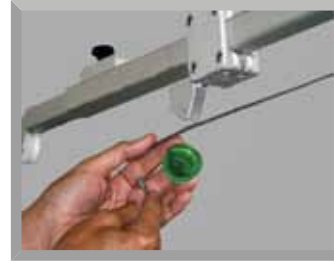

2.) Attach the RoTractor® adapter using the new screw, washer and acorn nut.

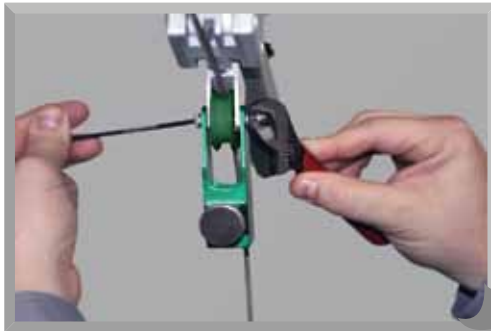

3.) Insert RoTractor® extension into adapter with receiver hole facing knurled "threaded" knob.



4.) Lock RoTractor® extension into adapter by tightening knob.

# De Mayo RoTractor® Assembly Instructions pg.2

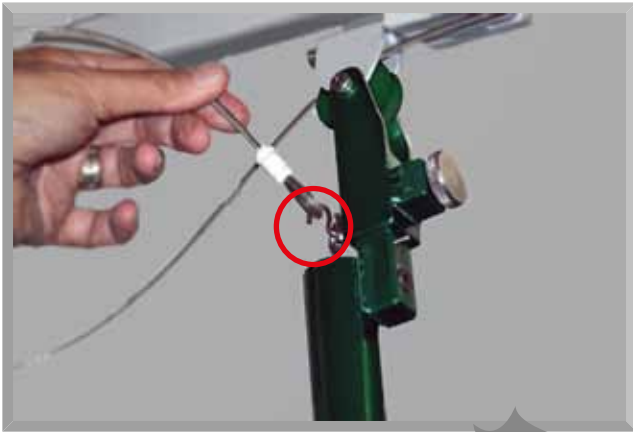

5.) Replace existing hook with small "S" hook provided. Attach traction wire to eyelet in RoTractor® extension, and....

...pull wire into extension.

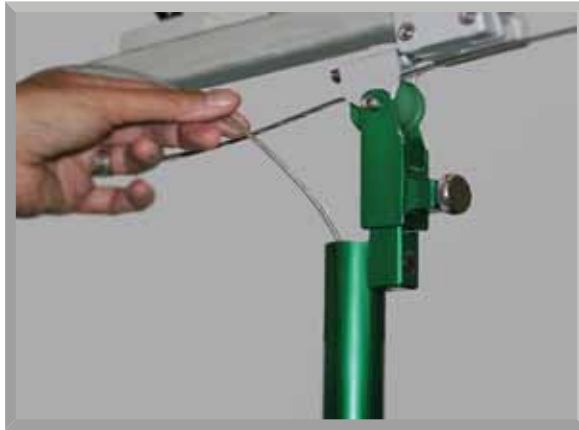

De Mayo RoTractor® Attachment is complete.

Attach patient's arm with sterile or non-sterile Phase 4 Gel™ Splint to the RoTractor® end plate.



CE

De Mayo RoTractor® is a registered trademark of Innovative Medical Products, Inc.  
De Mayo RoTractor® - PATENT APPLIED FOR  
Phase 4 Gel™ Splint is a trademark of Innovative Medical Products, Inc.  
Phase 4 Gel™ Splint - PATENT APPLIED FOR  
© February 2014 *ism*/ Innovative Medical Products, Inc. ALL RIGHTS RESERVED

 ***ism*** *Innovative Sports Medicine®*  
A DIVISION OF INNOVATIVE MEDICAL PRODUCTS, INC.  
87 Spring Lane, PO Box 8028  
Plainville, CT 06062  
PH: (860) 793-0391 FAX: (866) 459-1805  
Toll Free PH: 1-800-467-4944  
[www.impmedical.com](http://www.impmedical.com)